

# VW SERIES

2019 SPEC/PRICE

クロスビー

# VW SERIES



19" FLAT RIM / STANDARD SPOKE  
(Rim Depth 147mm)

20" STEP RIM / STANDARD SPOKE  
(Rim Depth 118mm)

20" STEP RIM / EXTEND SPOKE  
(Rim Depth 52mm)

## VWS-1

19"	20"
19x8	20x8
19x8.5	20x8.5
19x9	20x9
19x9.5	20x9.5
19x10	20x10
19x10.5	20x10.5
19x11	20x11
19x11.5	20x11.5
19x12	20x12
19x12.5	20x12.5

## 19"

19x8  
19x8.5  
19x9  
19x9.5  
19x10  
19x10.5  
19x11  
19x11.5  
19x12  
19x12.5

## 20"

20x8  
20x8.5  
20x9  
20x9.5  
20x10  
20x10.5  
20x11  
20x11.5  
20x12  
20x12.5

## VWS-2



19" FLAT RIM / STANDARD SPOKE  
(Rim Depth 147mm)

20" STEP RIM / STANDARD SPOKE  
(Rim Depth 118mm)

20" STEP RIM / EXTEND SPOKE  
(Rim Depth 52mm)

## 19"

19x8  
19x8.5  
19x9  
19x9.5  
19x10  
19x10.5  
19x11  
19x11.5  
19x12  
19x12.5

## 20"

20x8  
20x8.5  
20x9  
20x9.5  
20x10  
20x10.5  
20x11  
20x11.5  
20x12  
20x12.5

## VWS-3



19"/21" FLAT RIM / STANDARD SPOKE  
(Rim Depth 147mm)

20"/22" STEP RIM / STANDARD SPOKE  
(Rim Depth 118mm)

20"/22" STEP RIM / EXTEND SPOKE  
(Rim Depth 52mm)

## 21"

21x8.5  
21x9.0  
21x9.5  
21x10.0  
21x10.5  
21x11.0  
21x11.5  
21x12.0  
21x12.5

## 22"

22x8.5  
22x9.0  
22x9.5  
22x10.0  
22x10.5  
22x11.0  
22x11.5  
22x12.0  
22x12.5



VOSSEN



Two-piece Wheel

# INSET RANGE for each Size

## ▲SPECIFICATIONS 20inch / STEP RIM REVERSE (STANDARD SPOKE)

SIZE	FLAT			DEEP		
	BIG CALIPER Rdisk	STANDARD Adisk	DEEP RIM Odisk	BIG CALIPER Rdisk	STANDARD Adisk	DEEP RIM Odisk
	INSET(RIM DEPTH)mm	INSET(RIM DEPTH)mm	INSET(RIM DEPTH)mm	INSET(RIM DEPTH)mm	INSET(RIM DEPTH)mm	INSET(RIM DEPTH)mm
20×8.0J	19(35)~-12(66)	32(35)~1(66)	47(35)~16(66)	-15(35)~-46(66)	-2(35)~-33(66)	13(35)~-18(66)
20×8.5J	26(35)~-19(80)	39(35)~-6(80)	54(35)~9(80)	-8(35)~-53(80)	5(35)~-40(80)	20(35)~-25(80)
20×9.0J	32(35)~-25(92)	45(35)~-12(92)	60(35)~3(92)	-2(35)~-59(92)	11(35)~-46(92)	26(35)~-31(92)
20×9.5J	38(35)~-31(104)	51(35)~-18(104)	66(35)~-3(104)	4(35)~-65(104)	17(35)~-52(104)	32(35)~-37(104)
20×10.0J	45(35)~-38(118)	58(35)~-25(118)	73(35)~-10(118)	11(35)~-72(118)	24(35)~-59(118)	39(35)~-44(118)
20×10.5J	51(35)~-44(130)	64(35)~-31(130)	79(35)~-16(130)	17(35)~-78(130)	30(35)~-65(130)	45(35)~-50(130)
20×11.0J	57(35)~-50(142)	70(35)~-37(142)	85(35)~-22(142)	23(35)~-84(142)	36(35)~-71(142)	51(35)~-56(142)
20×11.5J	64(35)~-57(156)	77(35)~-44(156)	92(35)~-29(156)	30(35)~-91(156)	43(35)~-78(156)	58(35)~-63(156)
20×12.0J	64(41)~-63(168)	77(41)~-50(168)	92(41)~-35(168)	30(41)~-97(168)	43(41)~-84(168)	58(41)~-69(168)
20×12.5J	57(54)~-69(180)	70(54)~-56(180)	85(54)~-41(180)	23(54)~-103(180)	36(54)~-90(180)	51(54)~-75(180)
特殊P.C.D.	5H-100~130					

●INCLUDINGS : CENTER CAP/1PC・VALVE STEM/1PC(V24C)

## ▲SPECIFICATIONS 20inch / STEP RIM REVERSE (EXTEND SPOKE)

SIZE	FLAT			DEEP		
	BIG CALIPER Rdisk	STANDARD Adisk	DEEP RIM Odisk	BIG CALIPER Rdisk	STANDARD Adisk	DEEP RIM Odisk
	INSET(RIM DEPTH)mm	INSET(RIM DEPTH)mm	INSET(RIM DEPTH)mm	INSET(RIM DEPTH)mm	INSET(RIM DEPTH)mm	INSET(RIM DEPTH)mm
20×8.0J	19(35)~-2(52)	32(35)~15(52)	47(35)~30(52)	-15(35)~-32(52)	-2(35)~-19(52)	13(35)~-4(52)
20×8.5J	26(35)~9(52)	39(35)~22(52)	54(35)~37(52)	-8(35)~-25(52)	5(35)~-12(52)	20(35)~3(52)
20×9.0J	32(35)~15(52)	45(35)~28(52)	60(35)~43(52)	-2(35)~-19(52)	11(35)~-6(52)	26(35)~9(52)
20×9.5J	38(35)~21(52)	51(35)~34(52)	66(35)~49(52)	4(35)~-13(52)	17(35)~0(52)	32(35)~15(52)
20×10.0J	45(35)~28(52)	58(35)~41(52)	73(35)~56(52)	11(35)~-6(52)	24(35)~7(52)	39(35)~22(52)
20×10.5J	51(35)~34(52)	64(35)~47(52)	79(35)~62(52)	17(35)~0(52)	30(35)~13(52)	45(35)~28(52)
20×11.0J	57(35)~40(52)	70(35)~53(52)	85(35)~68(52)	23(35)~6(52)	36(35)~19(52)	51(35)~34(52)
20×11.5J	64(35)~47(52)	77(35)~60(52)	92(35)~75(52)	30(35)~13(52)	43(35)~26(52)	58(35)~41(52)
20×12.0J	64(41)~53(52)	77(41)~66(52)	92(41)~81(52)	30(41)~19(52)	43(41)~32(52)	58(41)~47(52)
特殊P.C.D.	5H-100~130					

●INCLUDINGS : CENTER CAP/1PC・VALVE STEM/1PC(V24C)

## ▲SPECIFICATIONS 19inch / FLAT RIM REVERSE (STANDARD SPOKE)

SIZE	FLAT			DEEP		
	BIG CALIPER Rdisk	STANDARD Adisk	DEEP RIM Odisk	BIG CALIPER Rdisk	STANDARD Adisk	DEEP RIM Odisk
	INSET(RIM DEPTH)mm	INSET(RIM DEPTH)mm	INSET(RIM DEPTH)mm	INSET(RIM DEPTH)mm	INSET(RIM DEPTH)mm	INSET(RIM DEPTH)mm
19×7.5J	13(36)~-10(59)	26(36)~3(59)	41(36)~18(59)	-18(33)~-44(59)	-5(33)~-31(59)	10(33)~-16(59)
19×8.0J	19(36)~-16(71)	32(36)~-3(71)	47(36)~12(71)	-12(33)~-50(71)	1(33)~-37(71)	16(33)~-22(71)
19×8.5J	26(36)~-23(85)	39(36)~-10(85)	54(36)~5(85)	-5(33)~-57(85)	8(33)~-44(85)	23(33)~-29(85)
19×9.0J	32(36)~-29(97)	45(36)~-16(97)	60(36)~-1(97)	1(33)~-63(97)	14(33)~-50(97)	29(33)~-35(97)
19×9.5J	38(36)~-35(109)	51(36)~-22(109)	66(36)~-7(109)	7(33)~-69(109)	20(33)~-56(109)	35(33)~-41(109)
19×10.0J	45(36)~-42(123)	58(36)~-29(123)	73(36)~-14(123)	14(33)~-76(123)	27(33)~-63(123)	42(33)~-48(123)
19×10.5J	51(36)~-48(135)	64(36)~-35(135)	79(36)~-20(135)	20(33)~-82(135)	33(33)~-69(135)	48(33)~-54(135)
19×11.0J	57(36)~-54(147)	70(36)~-41(147)	85(36)~-26(147)	26(33)~-88(147)	39(33)~-75(147)	54(33)~-60(147)
19×11.5J	64(36)~-61(161)	77(36)~-48(161)	92(36)~-33(161)	33(33)~-95(161)	46(33)~-82(161)	61(33)~-67(161)
19×12.0J	64(42)~-67(173)	77(42)~-54(173)	92(42)~-39(173)	30(42)~-101(173)	43(42)~-88(173)	58(42)~-73(173)
19×12.5J	57(55)~-73(185)	70(55)~-60(185)	85(55)~-45(185)	23(55)~-107(185)	36(55)~-94(185)	51(55)~-79(185)
特殊P.C.D.	5H-100~130					

●INCLUDINGS : CENTER CAP/1PC・VALVE STEM/1PC(V24C)

# INSET RANGE for each Size

## ▲SPECIFICATIONS 22inch / STEP RIM REVERSE (STANDARD SPOKE)

SIZE	FLAT			DEEP		
	BIG CALIPER Rdisk	STANDARD Adisk	DEEP RIM Odisk	BIG CALIPER Rdisk	STANDARD Adisk	DEEP RIM Odisk
	INSET(RIM DEPTH)mm	INSET(RIM DEPTH)mm	INSET(RIM DEPTH)mm	INSET(RIM DEPTH)mm	INSET(RIM DEPTH)mm	INSET(RIM DEPTH)mm
22×8.5J	26(35)~-12(73)	39(35)~1(73)	54(35)~16(73)	-8(35)~-46(73)	5(35)~-33(73)	20(35)~-18(73)
22×9.0J	32(35)~-18(85)	45(35)~-5(85)	60(35)~10(85)	-2(35)~-52(85)	11(35)~-39(85)	26(35)~-24(85)
22×9.5J	38(35)~-24(97)	51(35)~-11(97)	66(35)~4(97)	4(35)~-58(97)	17(35)~-45(97)	32(35)~-30(97)
22×10.0J	45(35)~-31(111)	58(35)~-18(111)	73(35)~-3(111)	11(35)~-65(111)	24(35)~-52(111)	39(35)~-37(111)
22×10.5J	51(35)~-37(123)	64(35)~-24(123)	79(35)~-9(123)	17(35)~-71(123)	30(35)~-58(123)	45(35)~-43(123)
22×11.0J	57(35)~-43(135)	70(35)~-30(135)	85(35)~-15(135)	23(35)~-77(135)	36(35)~-64(135)	51(35)~-49(135)
22×11.5J	64(35)~-50(149)	77(35)~-37(149)	92(35)~-22(149)	30(35)~-84(149)	43(35)~-71(149)	58(35)~-56(149)
22×12.0J	64(41)~-56(161)	77(41)~-43(161)	92(41)~-28(161)	30(41)~-90(161)	43(41)~-77(161)	58(41)~-62(161)
22×12.5J	57(54)~-62(173)	70(54)~-49(173)	85(54)~-34(173)	23(54)~-96(173)	36(54)~-83(173)	51(54)~-68(173)
特殊P.C.D.	5H-100~130					

●INCLUDINGS: CENTER CAP/1PC・VALVE STEM/1PC(V24C)

## ▲SPECIFICATIONS 22inch / STEP RIM REVERSE (EXTEND SPOKE)

SIZE	FLAT			DEEP		
	BIG CALIPER Rdisk	STANDARD Adisk	DEEP RIM Odisk	BIG CALIPER Rdisk	STANDARD Adisk	DEEP RIM Odisk
	INSET(RIM DEPTH)mm	INSET(RIM DEPTH)mm	INSET(RIM DEPTH)mm	INSET(RIM DEPTH)mm	INSET(RIM DEPTH)mm	INSET(RIM DEPTH)mm
22×8.5J	26(35)~9(52)	39(35)~22(52)	54(35)~37(52)	-8(35)~-25(52)	5(35)~-12(52)	20(35)~3(52)
22×9.0J	32(35)~15(52)	45(35)~28(52)	60(35)~43(52)	-2(35)~-19(52)	11(35)~-6(52)	26(35)~9(52)
22×9.5J	38(35)~21(52)	51(35)~34(52)	66(35)~49(52)	4(35)~-13(52)	17(35)~0(52)	32(35)~15(52)
22×10.0J	45(35)~28(52)	58(35)~41(52)	73(35)~56(52)	11(35)~-6(52)	24(35)~7(52)	39(35)~22(52)
22×10.5J	51(35)~34(52)	64(35)~47(52)	79(35)~62(52)	17(35)~0(52)	30(35)~13(52)	45(35)~28(52)
22×11.0J	57(35)~40(52)	70(35)~53(52)	85(35)~68(52)	23(35)~6(52)	36(35)~19(52)	51(35)~34(52)
22×11.5J	64(35)~47(52)	77(35)~60(52)	92(35)~75(52)	30(35)~13(52)	43(35)~26(52)	58(35)~41(52)
22×12.0J	64(41)~53(52)	77(41)~66(52)	92(41)~81(52)	30(41)~19(52)	43(41)~32(52)	58(41)~47(52)
22×12.5J						
特殊P.C.D.	5H-100~130					

●INCLUDINGS: CENTER CAP/1PC・VALVE STEM/1PC(V24C)

## ▲SPECIFICATIONS 21inch / FLAT RIM REVERSE (STANDARD SPOKE)

SIZE	FLAT			DEEP		
	BIG CALIPER Rdisk	STANDARD Adisk	DEEP RIM Odisk	BIG CALIPER Rdisk	STANDARD Adisk	DEEP RIM Odisk
	INSET(RIM DEPTH)mm	INSET(RIM DEPTH)mm	INSET(RIM DEPTH)mm	INSET(RIM DEPTH)mm	INSET(RIM DEPTH)mm	INSET(RIM DEPTH)mm
21×8.5J	26(35)~-8(69)	39(35)~5(69)	54(35)~20(69)	-6(33)~-42(69)	7(33)~-29(69)	22(33)~-14(69)
21×9.0J	32(35)~-14(81)	45(35)~-1(81)	60(35)~14(81)	0(33)~-48(81)	13(33)~-35(81)	28(33)~-20(81)
21×9.5J	38(35)~-20(93)	51(35)~-7(93)	66(35)~8(93)	6(33)~-54(93)	19(33)~-41(93)	34(33)~-26(93)
21×10.0J	45(35)~-27(107)	58(35)~-14(107)	73(35)~1(107)	13(33)~-61(107)	26(33)~-48(107)	41(33)~-33(107)
21×10.5J	51(35)~-33(119)	64(35)~-20(119)	79(35)~-5(119)	19(33)~-67(119)	32(33)~-54(119)	47(33)~-39(119)
21×11.0J	57(35)~-39(131)	70(35)~-26(131)	85(35)~-11(131)	25(33)~-73(131)	38(33)~-60(131)	53(33)~-45(131)
21×11.5J	64(35)~-46(145)	77(35)~-33(145)	92(35)~-18(145)	32(33)~-80(145)	45(33)~-67(145)	60(33)~-52(145)
21×12.0J	64(41)~-52(157)	77(41)~-39(157)	92(41)~-24(157)	30(41)~-86(157)	43(41)~-73(157)	58(41)~-58(157)
21×12.5J	57(54)~-58(169)	70(54)~-45(169)	85(54)~-30(169)	23(54)~-92(169)	36(54)~-79(169)	51(54)~-64(169)
特殊P.C.D.	5H-100~130					

●INCLUDINGS: CENTER CAP/1PC・VALVE STEM/1PC(V24C/V39A)

# VW SERIES

Two-piece structure

19inch	
RIM TYPE	FLAT RIM

Size	Price
19x8	¥122,000
19x8.5	
19x9	
19x9.5	¥126,000
19x10	
19x10.5	
19x11	¥130,000
19x11.5	
19x12	
19x12.5	

20inch	
RIM TYPE	STEP RIM

Size	Price
20x8	¥132,000
20x8.5	
20x9	
20x9.5	¥136,000
20x10	
20x10.5	
20x11	¥140,000
20x11.5	
20x12	
20x12.5	

21inch	
RIM TYPE	FLAT RIM

Size	Price
21x8.5	¥142,000
21x9.0	
21x9.5	
21x10.0	¥146,000
21x10.5	
21x11.0	
21x11.5	¥150,000
21x12.0	
21x12.5	

22inch	
RIM TYPE	STEP RIM

Size	Price
22x8.5	¥152,000
22x9.0	
22x9.5	
22x10.0	¥156,000
22x10.5	
22x11.0	
22x11.5	¥160,000
22x12.0	
22x12.5	

### RIM FINISH OPTION

Polished Anodized	include
Brushed Anodized	¥10,000
Gloss or Matte Bronze	¥15,000
Gloss or Matte Black	¥15,000

### DISK COLOR

All solid color		include	
Silver	Matte Silver	Bronze	Matte Bronze
Gunmetal	Matte Gunmetal	Gold	Matte Gold
Black	Matte Black	RED	BLUE
Hyper Silver	White		

 MONDERA JAPAN INC.

※予告なく変更になる場合がございます

# ブレーキキャリパーチェックシート

ホイールマッチングを取る際にブレーキキャリパーの下記の各寸法が必要になる場合があります。  
詳しくはお問い合わせください。

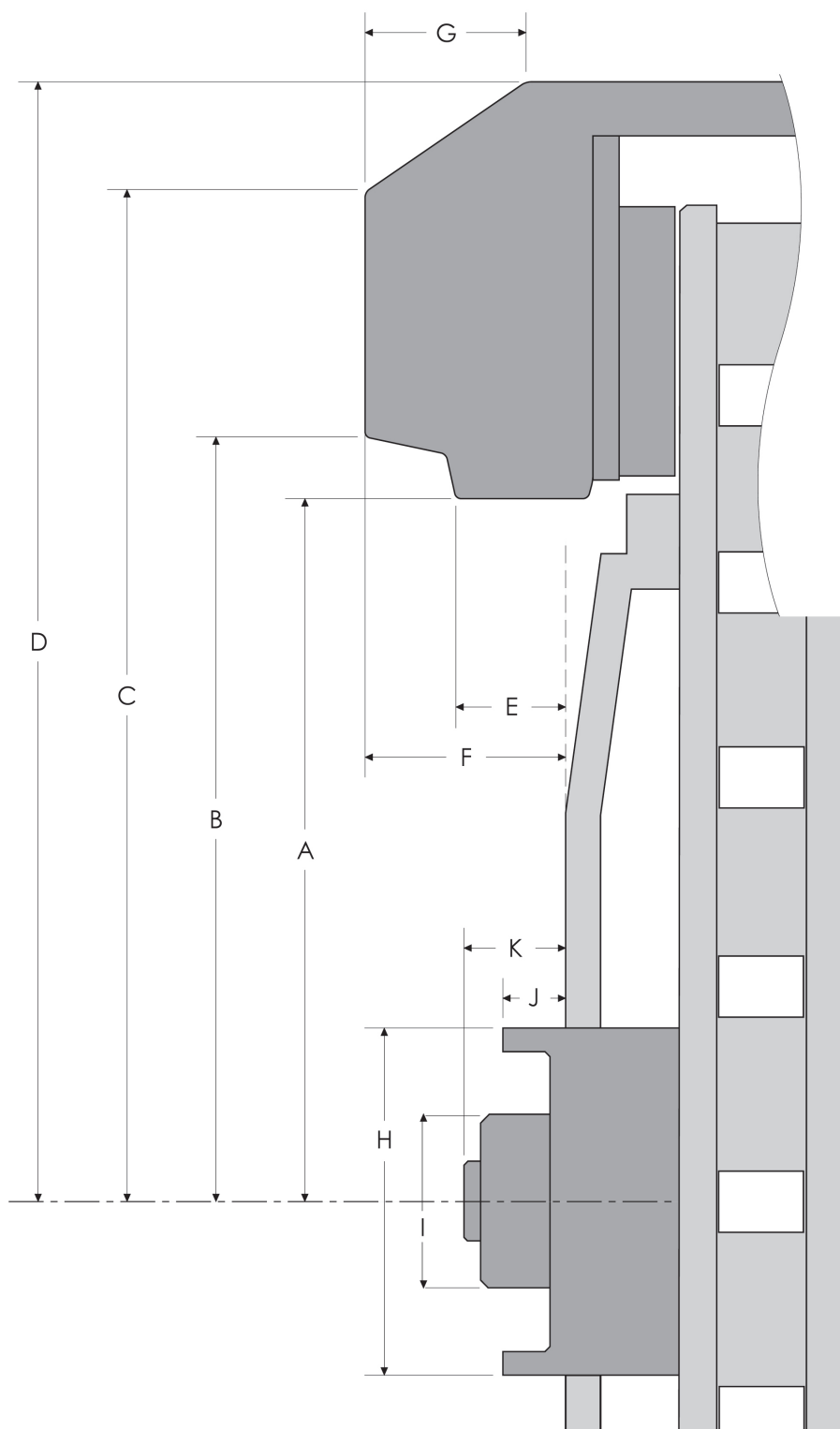

MEMO

---



---

<http://www.vossen.jp>

E-mail : [info@vossen.jp](mailto:info@vossen.jp)

 **MONDERA JAPAN INC.**

7992-8 Miyakoda, Kitaku, Hamamatsu, Shizuoka 431-2102 JAPAN

[info@monderajapan.com](mailto:info@monderajapan.com)

Customer support (Mon)~(Fri) 10:00~18:30

053.523.6388